



LIFTING AND TIPPING DEVICE FOR BOX PALLET - HYDRAULIC



Strojírna Pálava Maxima s.r.o.

DESÁTKOVÁ 124/15, 623 00 BRNO KOHOUTOVICE
Manufactory: TOVÁRNÍ 34, 679 32 SVITÁVKA, CZECH REPUBLIC
tel: +420 - 516 453 834, fax: +420 - 516 453 834
e-mail: info@s-palava.cz; www.s-palava.cz

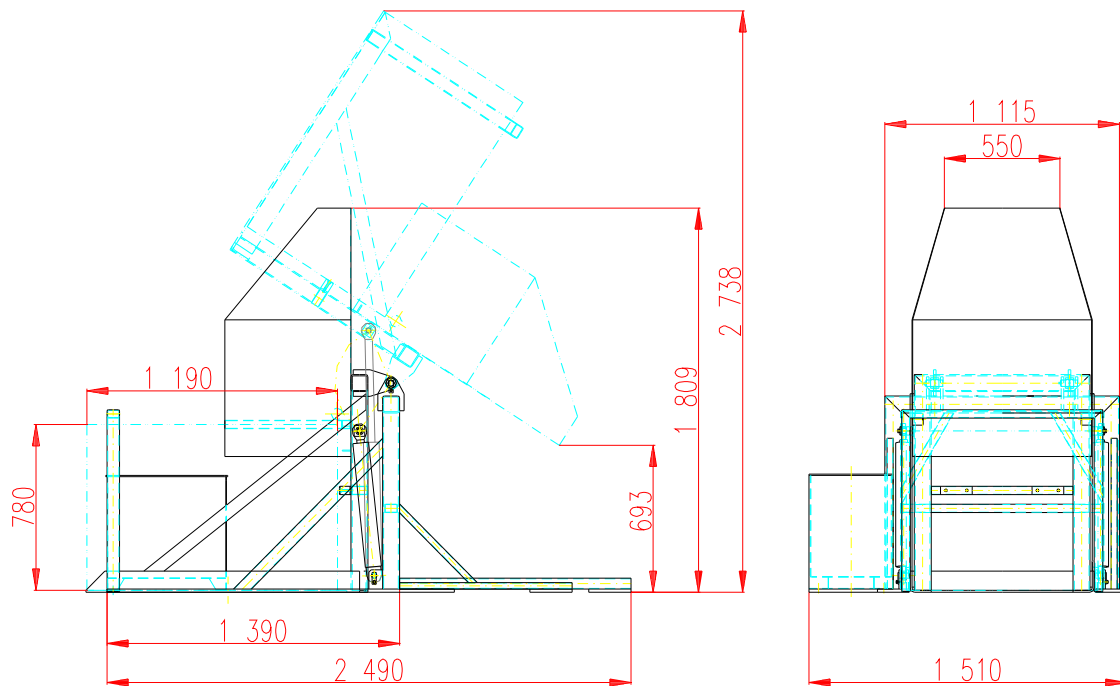

This device is used for lifting and tipping of box pallet's (1200 x 800 mm) content. The whole machine is made of closed stainless steel profiles. The lifting is done through two hydraulic cylinders. A part of the tipping device is feeding hopper where the box pallet is stuffed up with silicone gasket to avoid leaking the raw material from the pallet.

Technical data

Length	2490 mm
Width	1510 mm
Height	1810 mm
Weight	383 kg
Load capacity	500 kg
Engine power	2,2 kW
Voltage system	400/230 V – 50 Hz
IP code	IP 54